

SPECIFICATIONS OPL-310 Dry Lint Filter

The model **OPL-310** Filter collects lint produced from multiple laundry dryer applications. This unit requires minimal maintenance, simple to install and is a cost efficient solution to unsightly and potentially dangerous lint buildup.

Body: The housing is made out of fire retardant laminating resin (Fiberglass). The unit comes with four adjustable 1" aluminum pipe legs for floor mounting.

Filtering: An inner bag-like floating fine mesh screen (180 micron polyester) is designed to filter 98% of lint passing through the chamber.

Lint Collection: Lint drops or shaken off the screen into a fire retardant vinyl holding bag. The bag is equipped with two zippers for easy lint removal and screen cleaning.

Controls: A static pressure switch with audible alert is activated when a High Pressure situation occurs indicating the screen needs to be checked.

Max. Capacity: 10,000 CFM

Shipping Weight: 700 lbs.

Screen Area: 52 Sq. Ft.

Shipping Cube: 60"W x 60"L x 80"H

Screen Change Time: 5 min.

Ave. Static Press. drop (Filter) : 0.2" WC @ 8000 cfm

Electrical Req.: 110V, 50/60 Hz, 1 amp (for remote Pressure Switch only)

OPL - 310

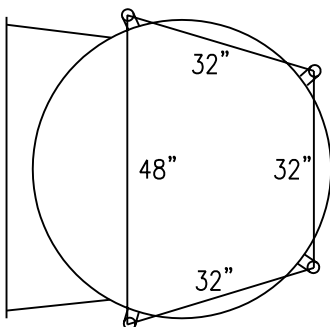
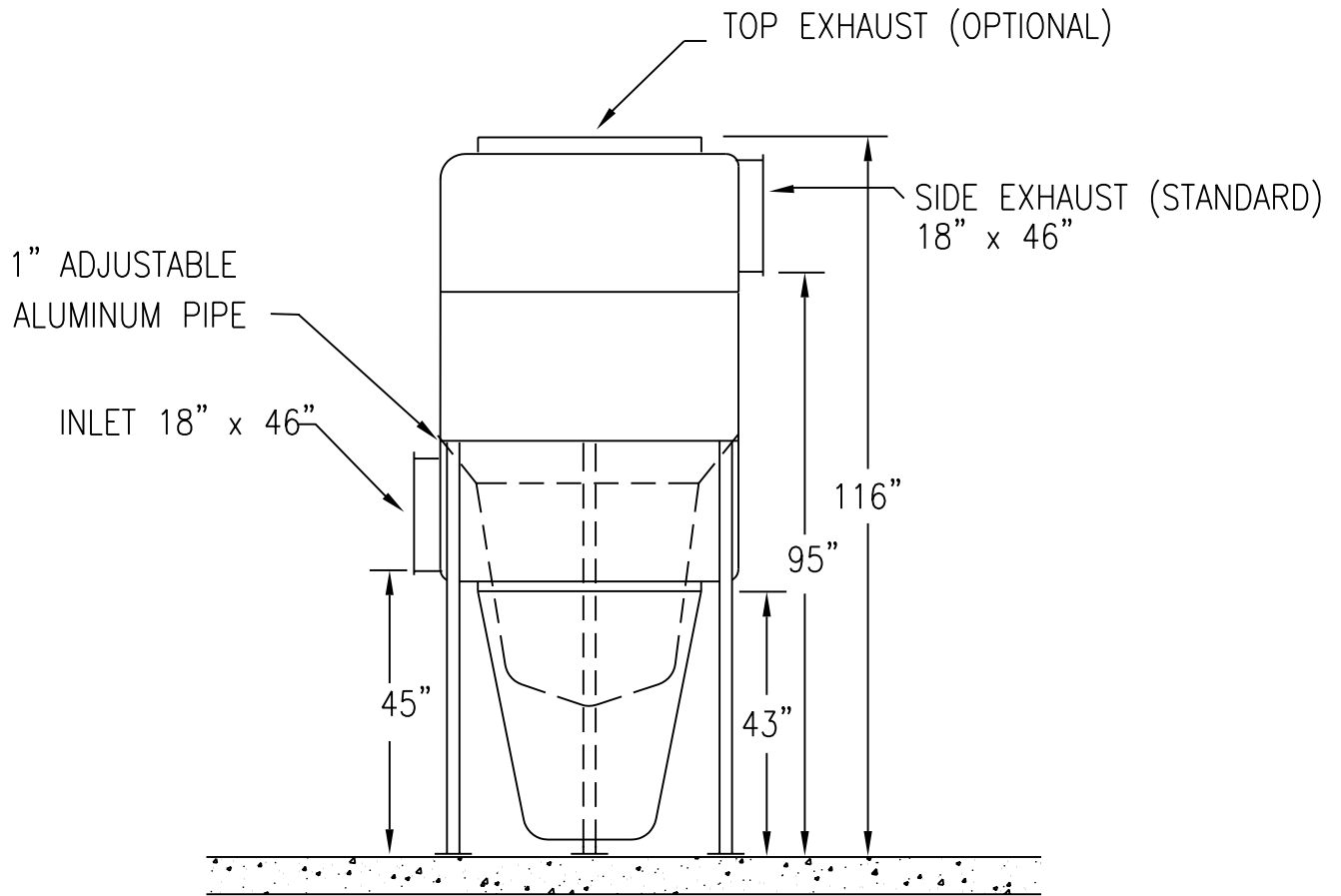
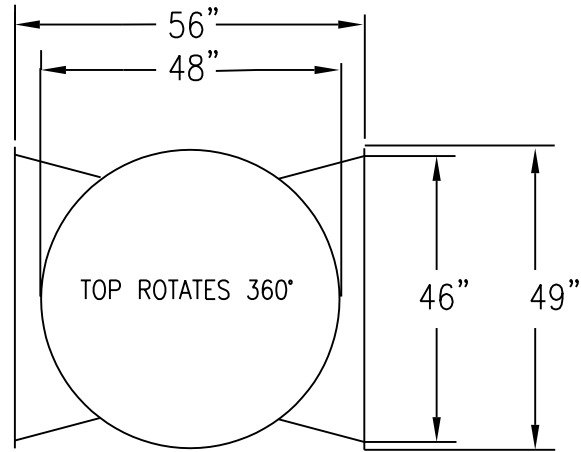

FLOOR FLANGE

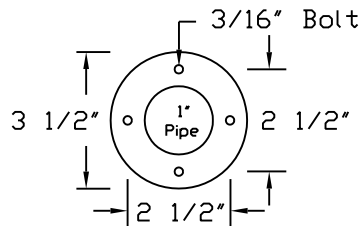

LINT FILTER-ASSEMBLY-INSTALLATION MODEL OPL-310 10,000 CFM

CLEAN CYCLE SYSTEMS

A DIVISION OF TQ INDUSTRIES

960 CROSSROADS BLVD., SEGUIN, TX 78155

830-401-4400

DATE 06/04

SCALE NONE

DRAWING NO.